



hotel nikko bangkok

JAPANESE HOSPITALITY OF

**“OMOTENASHI”**

*Indulge in Impeccable Service  
of Japanese Mind*



## HOTEL INFORMATION



Hotel Nikko Bangkok located in **THE HEART OF BANGKOK**, Sukhumvit 55 Soi Thonglor - The trendiest neighborhood with a wide variety of tourist hot spots - restaurants, bars and shopping centers.

- Our 301 guest rooms feature thoughtful amenities, including day beds, work desks, free Wi-Fi, and more.

Enjoy comfortable, functional, and stylish accommodation.

- Over 700 square meters of meeting space and 9 functional rooms are available.
- 3 Restaurants & Bar: HISHOU (Japanese Restaurant), The Oasis (All-Day Dining), and Curve 55 (Lobby Lounge).

# LOCATION



## IN THE HEART OF BANGKOK

- Suvarnabhumi International Airport - 24 Kilometers
- Don Mueang Airport - 31 Kilometers
- Thonglor BTS Skytrain Station Exit 1, 3 - 2 Minutes Walk
- Siam BTS Skytrain Station - 20 Minutes
- The EmQuartier / The Emporium / EmSphere - 1.5 Kilometers
- SHOW DC - 5 Kilometers
- Samitivej Hospital - 1.5 Kilometers
- Benjasiri Park - 1.8 Kilometers
- Queen Sirikit National Convention Center (QSNCC) - 4.5 Kilometers
- Bangkok International Trade and Exhibition Centre (BITEC) - 8 Kilometers

## UNIQUE SELLING POINT



- Only 3-minute walk from BTS, Thonglor Station
- Japanese stylish room interior decoration and Thai touch with separate bathroom and toilet.
- 9 meeting and banquet facilities in the area, also have outdoor area for private party.
- 1,000 standing cocktails at day-light Grand Ballroom.
- International Buffet Breakfast together with Instyle Traditional Japanese Breakfast
- Cheerful and Friendly Omotenashi Service (Japanese Hospitality).

## LOBBY



Whether you are traveling for business or pleasure, offers lobby space to hold informal meetings, or just relax...



# ACCOMMODATION



## SUPERIOR ROOM

- 36 sqm.
- Deluxe Bathroom Amenities
- TOTO Washlet
- Independent Toilet Room
- Modern Japanese Style Interior
- SEALY Signature Bedding
- Hotel Signature Bed Linens
- Extensive Pillow Menu
- Superior Rooms are located on 8<sup>th</sup> - 12<sup>th</sup> Floor
- Superior Plus Rooms are located on 14<sup>th</sup> – 19<sup>th</sup> Floor

## SUPERIOR ROOM



# ACCOMMODATION



## PREMIER ROOM

- 45 – 52 (Premier Corner / Plus) sqm.
- Deluxe Bathroom Amenities
- TOTO Washlet
- Independent Toilet Room
- Modern Japanese Style Interior
- SEALY Signature Bedding
- Hotel Signature Bed Linens
- Extensive Pillow Menu

## PREMIER ROOM



# ACCOMMODATION



## NIKKO CLUB

- 36 - 52 (Nikko Club Premier) sqm.
- Executive Lounge Privileges
- Deluxe Bathroom Amenities
- TOTO Washlet
- SEALY Signature Bedding
- Hotel Signature Bed Linens
- Extensive Pillow Menu
- Complimentary Mini-Bar
- NESPRESSO Coffee Maker

## NIKKO CLUB



# ACCOMMODATION



## NIKKO EXECUTIVE SUITE

- 79 sqm.
- Large Living Room
- Executive Lounge Privileges
- Deluxe Bathroom Amenities
- TOTO Washlet
- SEALY Signature Bedding
- Hotel Signature Bed Linens
- Extensive Pillow Menu
- Complimentary Mini-Bar
- NESPRESSO Coffee Maker

## NIKKO EXECUTIVE SUITE



# ACCOMMODATION



## NIKKO GRAND SUITE

- 130 sqm.
- Large Living Room
- Executive Lounge Privileges
- Deluxe Bathroom Amenities
- TOTO Washlet
- SEALY Signature Bedding
- Hotel Signature Bed Linens
- Extensive Pillow Menu
- Complimentary Mini-Bar
- NESPRESSO Coffee Maker

# NIKKO GRAND SUITE



## EXECUTIVE LOUNGE



Executive Lounge at our hotel is an inviting, well-appointed space accessible only to guests staying in the hotel's Suite categories or Nikko Club Rooms.

- Daily from 11:00-20:00 hrs.
- Personalized Check-In and Check-Out at Executive Lounge
- Complimentary Daily Breakfast at hotel restaurant
- Daily refreshments Non-Alcohol Beverages & Snacks from 11:00-20:00 hrs.
- Complimentary Afternoon Tea from 14:00- 16:00 hrs.
- Complimentary Evening Cocktail from 17:00-19:00 hrs.
- Complimentary Meeting Room Usage (One Hour per day)

## MEETING & EVENT

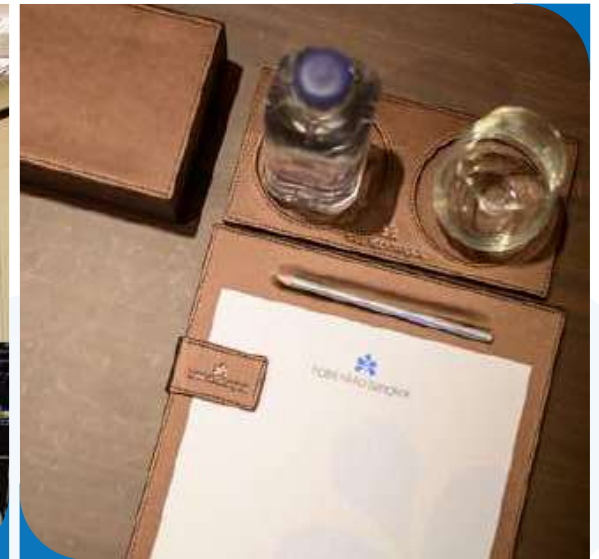

Hotel Nikko Bangkok is perfectly positioned for conferences, product launches, meetings, weddings, gala dinners and a variety of special events in our daylight function rooms and spacious outdoor terrace with the view of Bangkok Skyline. Our dedicated event specialists are ready to serve you to make your event a success!

- Total of over 1,800 square meters in 9 different function rooms throughout the hotel.
- Capacity from 10 to 1,000 persons to accommodate for small to large functions.
- State-of-the-art audio and visual equipment and IT support.
- 8 meter high ceiling to cater all creativities at FUJI GRAND BALLROOM.
- Easy direct access by elevators and escalators from parking and hotel lobby.

# FUJI

## GRAND BALLROOM

Space: 735 sqm. (370 sqm / 360 sqm) Max: 1,000 persons



Signature and large ballroom equipped with natural daylight, state-of-the-art audio and visual systems, including a **Stage LED Screen P1.87 (Pixel Pitch 1.87mm) and LCD screen with 4K support**, creating memorable meetings and parties. An ideal venue for weddings or conferences, this room can also be conveniently divided into two separate rooms (370 sqm / 360 sqm) by sound-proof partitions.



## SAKURA

**& TSUBAKI** Space: 97.5 sqm. Max: 100 persons

Provided with day-light, Sakura is an ideal venue for hosting more semi-large sized gatherings, private parties or business meetings. The room (SAKURA) has a partition which can divide the area into 2 separate rooms (61sqm / 38sqm) by sound-proof partitions.

**UME** Space: 82 sqm. Max: 50 persons

Perfect venues for medium-size functions such as seminars, corporate meetings and cocktail parties. These functional spaces feature the latest audio and visual and support equipment.



## KAEDE

Space: 25 sqm. Max: 10 persons

---

## MOMIJI

Space: 20 sqm. Max: 10 persons

These boardroom styled venues are perfect for small private business meetings providing luxurious and comfortable ambience.

---

## KASUMI

Space: 22 sqm. Max: 8 persons

An ideal space for small gatherings, VIP room for bride and groom.

Comfortably equipped with Sofas and lounge chairs.

# CAPACITY & FLOOR PLAN

## 4 FLOOR

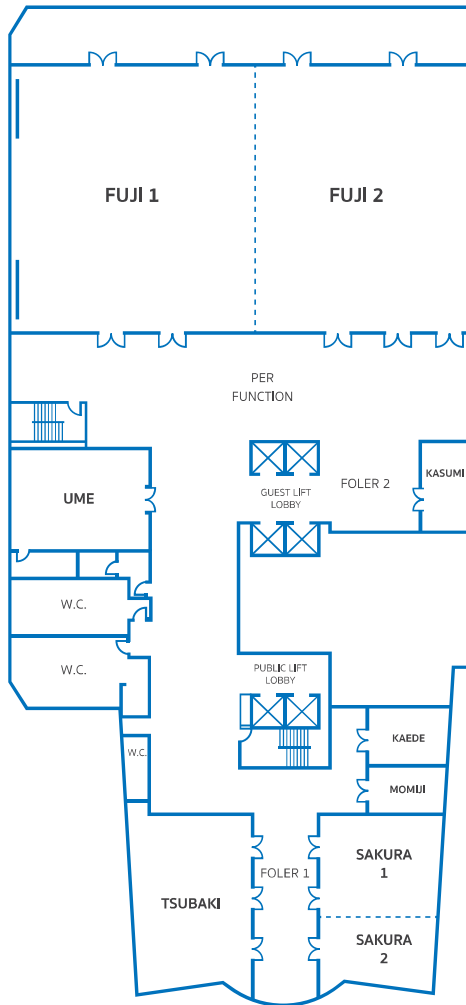

VENUE	DIMENSION			CAPACITY						
	AREA (M2)	HEIGHT (M)	LXW (M)	CLASS ROOM	THEATER	BANQUET	RECEPTION	BOARD ROOM	U-SHAPE	CABARET
Fuji Grand Ballroom	735	8	21.3 x 34.5	480	780	500	1,000	-	-	300
Fuji 1	370	8	21.3 x 17.3	240	320	200	400	-	-	138
Fuji 2	360	8	21.3 x 16.8	240	320	200	400	-	-	138
Sakura	97.5	4.2	13.3 x 7.5	54	100	60	60	26	28	36
Sakura 1	63	4.2	8.3 x 7.5	36	50	40	40	14	26	24
Sakura 2	36	4.2	4.8 x 7.5	12	20	20	20	10	12	12
Ume	82	4.2	7.8 x 10.5	45	50	50	50	20	24	30
Tsubaki	97.5	4.2	13.3 x 7.5	54	100	60	60	26	28	36
Kaede	25	4.2	4.1 x 6	-	-	-	-	10	-	-
Momiji	20	4.2	3.4 x 6	-	-	-	-	10	-	-
Kasumi	22	4.2	7.2 x 3	-	-	-	-	8	-	-
Per Function Area	250	4.5	8 x 31	-	-	-	200	-	-	-
**The Pool Terrace	240	-	24 x 10	-	-	150	200	-	-	-
**The Nikko Terrace	30	-	-	-	-	-	20	-	-	-

\*\* The Pool Terrace Located on 6<sup>th</sup> floor. / The Nikko Terrace Located on 21<sup>st</sup> floor.



**the oasis**  
ALL DAY DINING

*The best embracing  
international breakfast buffet  
also the best brunch in Bangkok.  
Serving down-to-earth culinary  
favorites from around the world.*

**LOCATION:**

6<sup>th</sup> Floor Capacity: 180 seats

**BREAKFAST**

Monday – Friday 05:30 – 10:30 hrs.

Saturday – Sunday 06:00 – 10:30 hrs.

**SATURDAY BRUNCH BUFFET**

12:00 – 15:00 hrs.

# RESTAURANTS



# RESTAURANTS

飛翔  
HISHOU

*A new dimension  
of Japanese dining*

**LOCATION:**

1<sup>st</sup> Floor Capacity: 70 seats

**LUNCH**

Monday – Sunday 11:30 – 14:30 hrs.

**DINNER**

Monday – Sunday 17:30 – 22:30 hrs.



*Enjoy your favorite beverage  
as you prefer for all-day drinks,  
Japanese afternoon tea  
and homemade bakery.*

**LOCATION:**

Lobby Capacity: 60 seats

**OPEN**

Monday – Sunday 07:00 – 21:00 hrs.

**AFTERNOON TEA**

Daily 11.00 – 16.00 hrs.

\*(advance booking 4 hrs / or 1 day before)

**RESTAURANTS**



# FACILITIES



## SWIMMING POOL

Location: 6<sup>th</sup> Floor

Open

Monday – Sunday from 06.00 – 22.00 hrs

---



## FITNESS CENTER

Location: 6<sup>th</sup> Floor

Open

24 hours daily

# SUSTAINABILITY

## SOLAR CELL SYSTEM

Location: Rooftop

Operating Hours: 24 hours daily

---



## NIKKO GARDEN

Location: 6<sup>th</sup> Floor

Open

Monday – Sunday from 06.00 – 22.00 hrs





# hotel nikko bangkok

27 Sukhumvit 55 (Soi Thonglor), Sukhumvit Road, Klongton Nuea,  
Wattana, Bangkok 10110 Thailand

Tel: +66 (0)2 080 2111 E-mail: [info@nikkobangkok.com](mailto:info@nikkobangkok.com)

[www.nikkobangkok.com](http://www.nikkobangkok.com)    [hotelnikkobangkok](#)

\*Some information may be changed without any notice.